



EZON Your Security
Digitalized

SHS-6020

Touch keypad technology / Innovative design /
Enhanced security

01 User-friendly accessibility



PIN Code



RF Card



RF Key tag



override

02 Increase your security with a random code

2 random numbers appear before you enter the PIN code in order to stop copycat entries and prevent fingerprint tracing.



Press the activate button



Press the displayed numbers in any order



Keypad will display all numbers



Enter your PIN code

03 Safety & convenience



Enhanced security

Physical jolts, unauthorized PIN numbers or cards activate the alarm



Weather resistant body

The circuit board is water-proof



Remote control

Please contact one of our trained technicians for remote control function(option)



Low battery indicator (alarm&light)

Lets you know when it is time to change batteries.



Emergency access

Jump start the lock with a 9V battery for instant power

Inner body structure

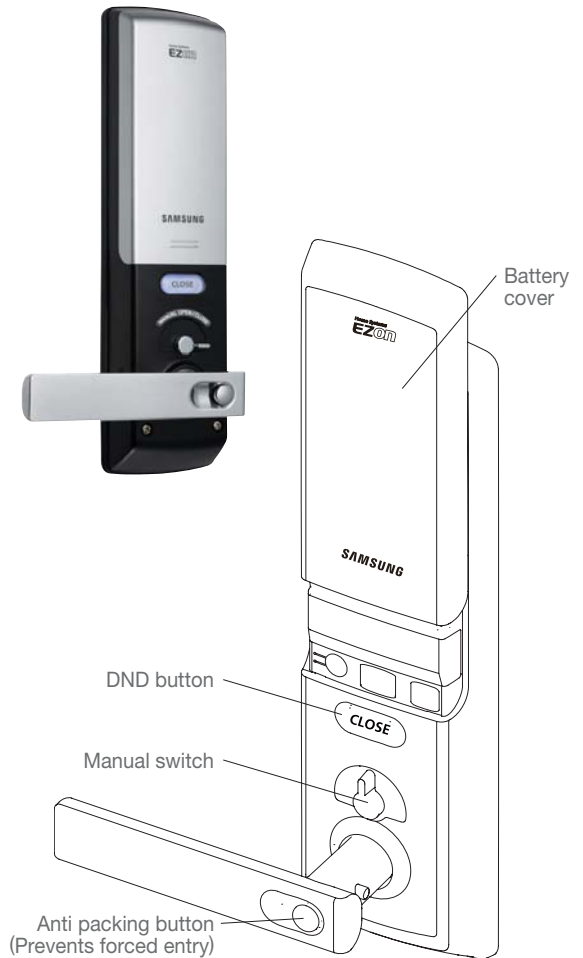

Section	SHS-6020
Key type	Smart card (13.56MHz RF chip/A Type), PIN
User capacity (Maximum)	20 Card Keys
PIN code combination	5~12 Digit number combination
Compatible door depth	1.5~2.4 (inch)
Material	Aluminium, Polycarbonate+Glass fiber, and acrylate
Humidity	20% ~ 80%
Power	DC 6V (8 AA Alkaline batteries)
Battery lifetime	Approximately 12 months (average use-10 times a day)
Product size	Outer body : 3.1X12.2X2.8 inch (WXHXD) Inner body : 3.1X11.4X3.1 inch (WXHXD)
Package size	11.8X 14.5 X 3.9 inch (WXHXD)

SEOUL COMMTECH CO., LTD.

Member of SAMSUNG

<http://www.scommtech.com/en>

448-11, Seongnae3-Dong, Kangdong-Ku, Seoul, Korea 134-033
Tel +82-2-2225-6709 Fax +82-2-2225-6073 E-mail sales.ezon@samsung.com